

LH-725 Locking handle

Key Controlled Outside trim for use with PR7085, PR7085P, and PR7100 concealed rod Panic Devices.

Uses Axim screw in Mortice cylinder with MS type CAM.

Not handed. (Field reversible).

All Axim Panic Exit Hardware is supplied with comprehensive instructions and full size templates for ease of installation.

Handle rotation 45° anti-clockwise from centre.

OR

Handle rotation 45° clockwise from centre.

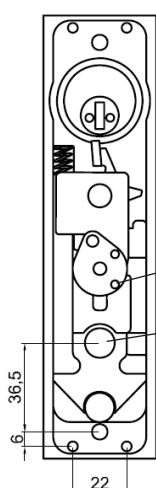
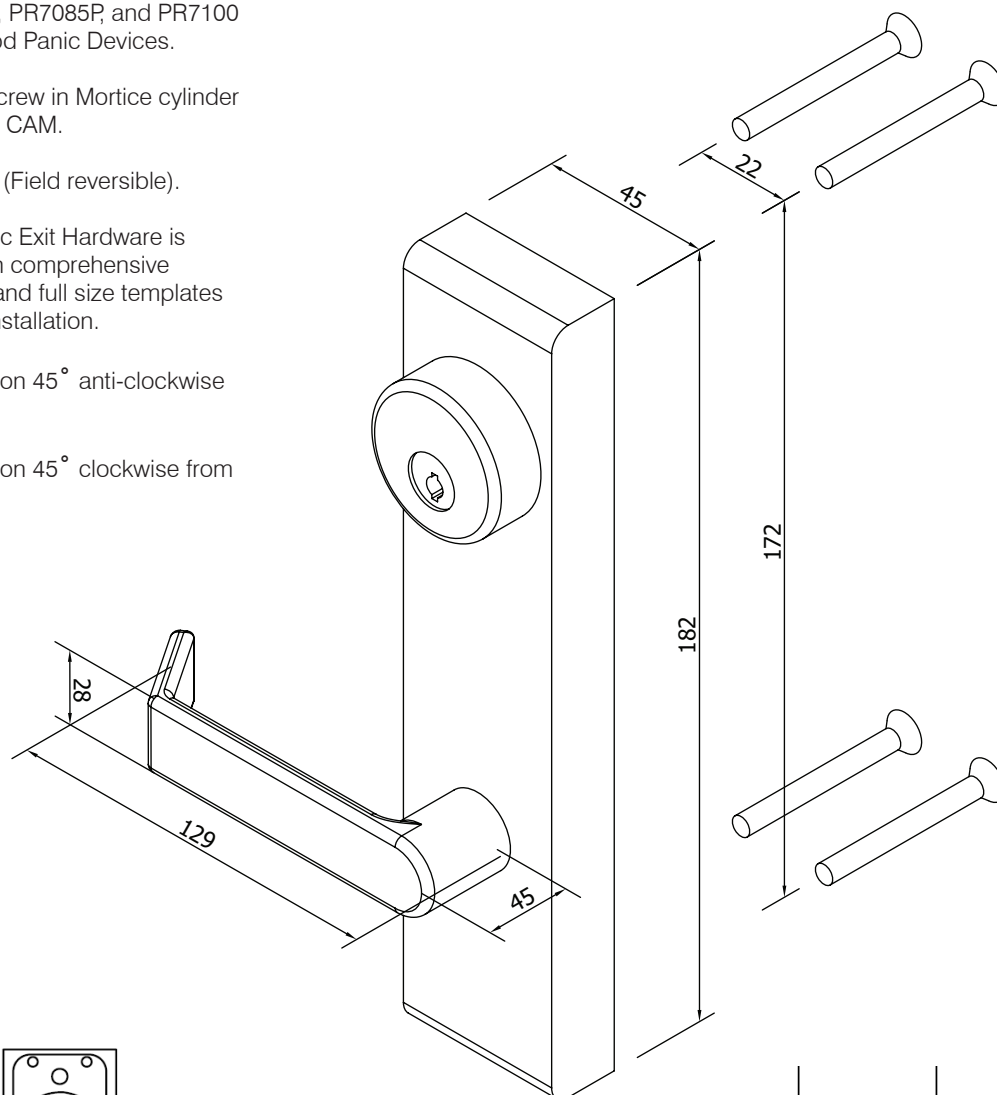

Ensure operating dowel is engaged in slot.

To change the hand of the trim, remove screw and reverse lever. Keep the black side of star washer facing upwards. Ensure screw is locked tight.

Ensure the cylinder and cam operate the lock arm prior to installation.

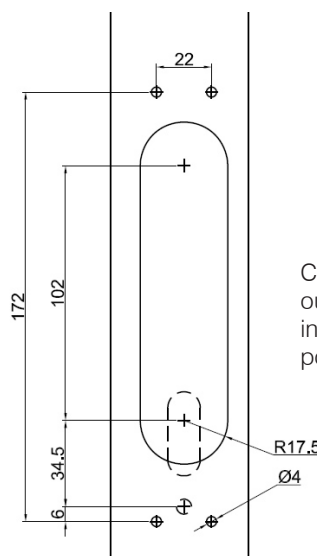

Cutting Prep to fit to outer face. Dashed lines indicate panic exit position (34.5 & 6).

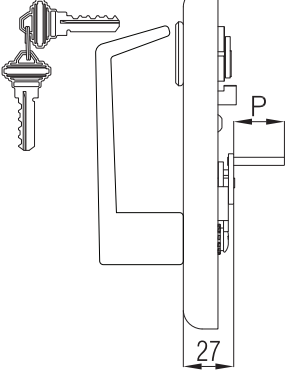
	Locking Handle	Pin Length	Door Stile
	LH-725	P = 6 mm	46mm
	LH-730	P = 9 mm	49mm
	LH-740	P = 14 mm	54mm
	LH-745	P = 27 mm	67mm
	LH-760	P = 23 mm	64mm

