

FS9500

Universal Application, Multi-Function Floor Hinge.

- One model, four optional spring strengths for every application
- Multiple functions as standard for reduced inventory
- Non-handed, for single or double action door
- Changeable spindle inserts available to suit field conditions
- Max. door weight up to 300kgs
- Hold-open angle available for 90° HO or NHO
- Mechanical Backcheck
- Closing speed variable by adjustable valve
- Max. door opening angle 180°

Technical Data

Spring size		3	4	5
Closing Force	Nm	15	34	44
	Door Width (mm)	Up to 800	800~1200	1200~1400

Cement box : 341x78x60 mm
(forward or backward total) : 6 mm

Hold Open

Hold-open: Available for 90°, 105° or no hold open, Without hold open, the max door opening can be 180°.

Backcheck

The backcheck helps to prevent damage of the door and wall when a door is opened with excessive force by people or the wind.

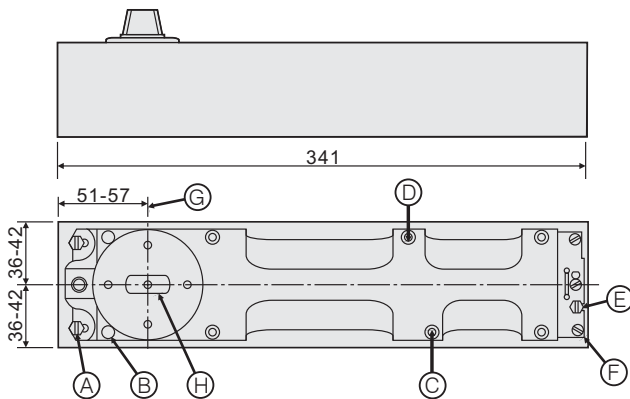
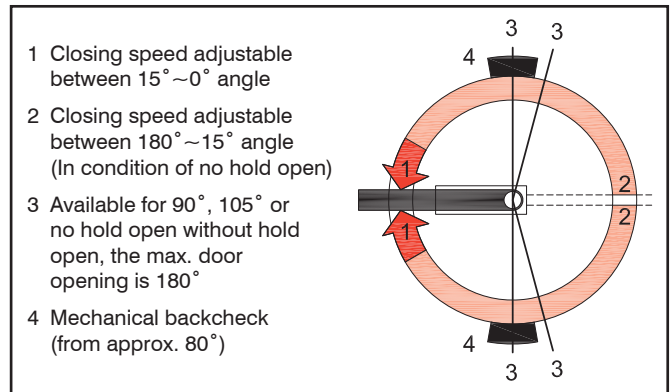

- A = Mounting Screws
- B = Height Adjustment Screws
- C = Latching Speed Valve
- D = Closing Speed Valve for Closing Speed
- E = Mounting Screws
- F = Height Adjustment Screws
- G = Spindle Backset Adjustment
- H = Changeable Spindle

1. Closing speed adjustable between 180°~15° angle
2. Latching speed adjustable between 15°~0° angle

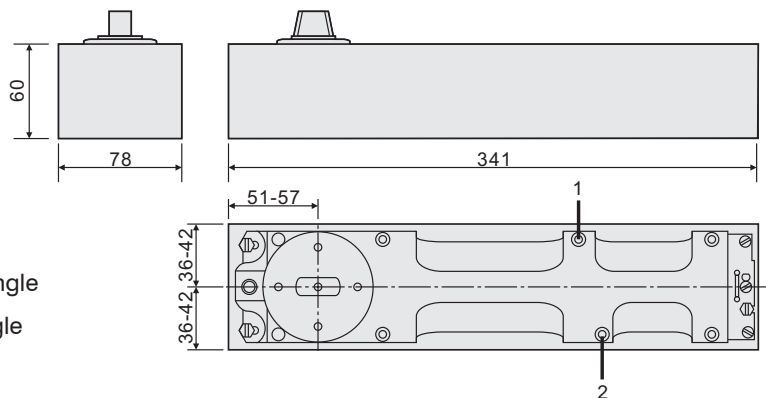
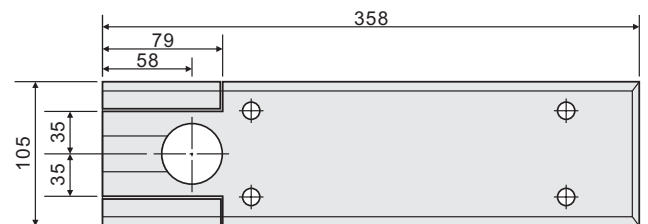

The Parkside Group Ltd

The Willow Centre
17 Willow Lane, Mitcham, Surrey, CR4 4NX
Tel: 020-8685 9685 Fax: 020-8646 5096
Email: axim@parksidegroup.co.uk
Web Site: www.axim.co.uk

SCALE NTS @A4
DATE JULY 2017

For scaled technical or CAD drawings, please contact AXIM.