

**Standard installation**

Closer mounted on door pull side

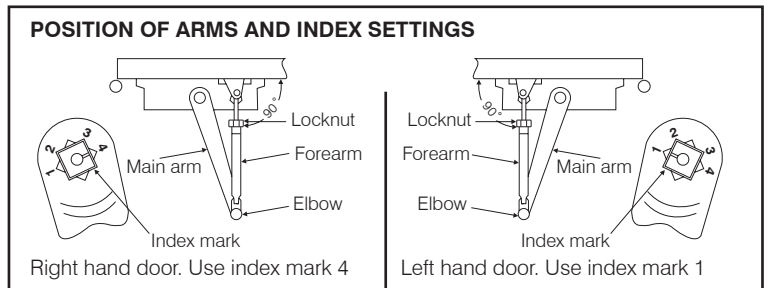
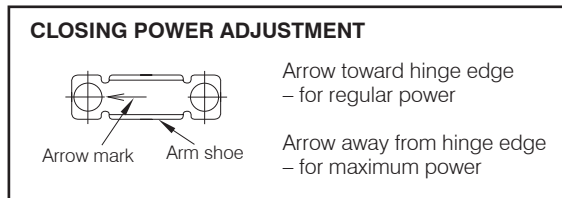
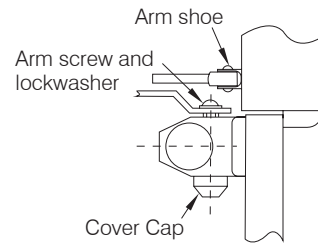
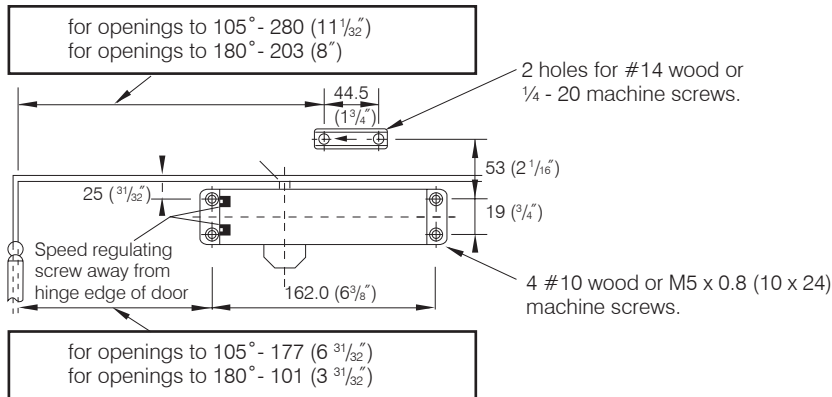

**Right hand door shown**

Same dimensions apply for left hand door measured from hinge edge.

**Top jamb installation**

Closer mounted on top jamb on push side of door.  
Reveals of 70 (2 3/4") to 127 (5") requires long top jamb forearms.

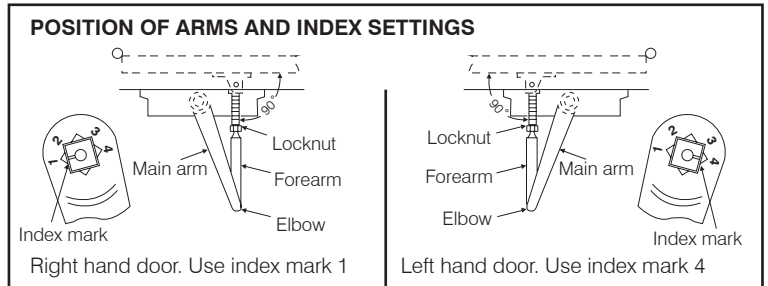
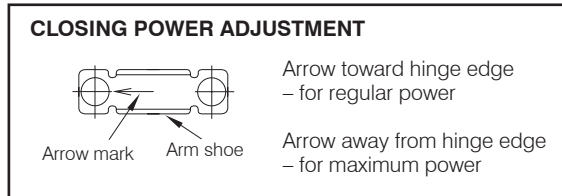
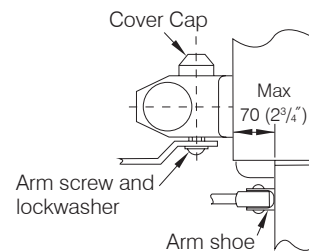
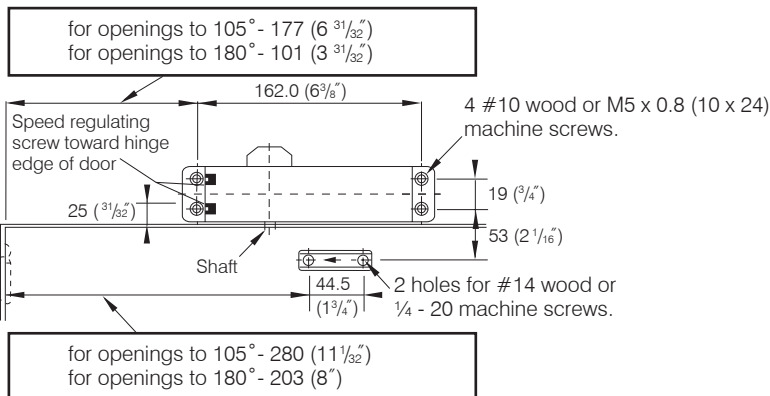

**Left hand door shown**

Same dimensions apply for right hand door measured from hinge edge.



The Parkside Group Ltd

The Willow Centre  
17 Willow Lane, Mitcham, Surrey, CR4 4NX  
Tel: 020-8685 9685 Fax: 020-8646 5096  
Email: axim@parksidegroup.co.uk  
Web Site: www.axim.co.uk

SCALE	NTS @A4
DATE	JULY 2020
For scaled technical or CAD drawings, please contact AXIM.	

**Parallel arm installation**

Closer mounted on door on push side

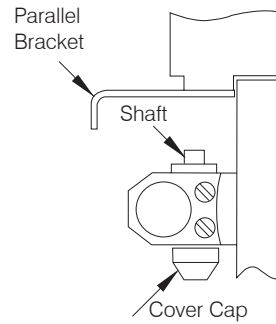
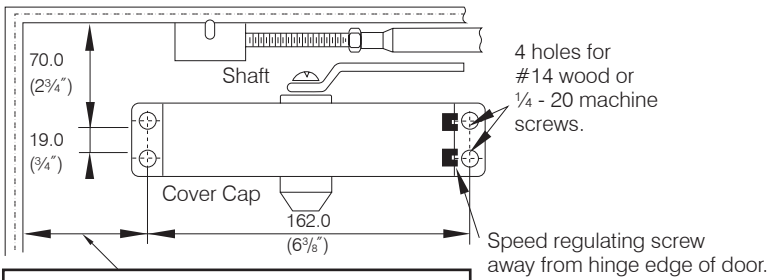

for openings to 105° - 220 (8<sup>21</sup>/<sub>32</sub>)  
for openings to 180° - 150 (5<sup>29</sup>/<sub>32</sub>)

for openings to 105° - 230 (9<sup>1</sup>/<sub>16</sub>)  
for openings to 180° - 160 (6<sup>19</sup>/<sub>64</sub>)

LEFT HAND DOOR shown.  
Same dimensions apply for right hand door  
measured from hinge edge.

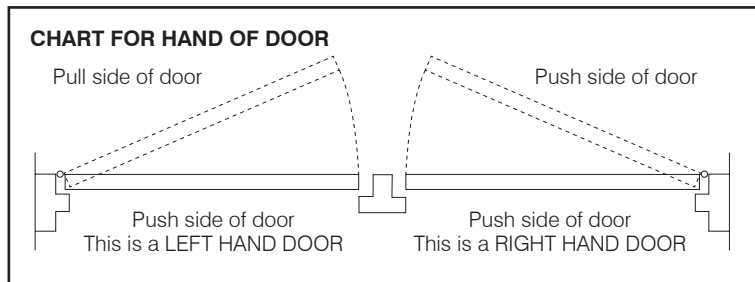
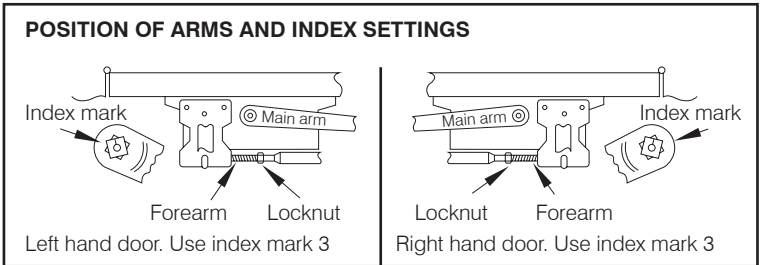
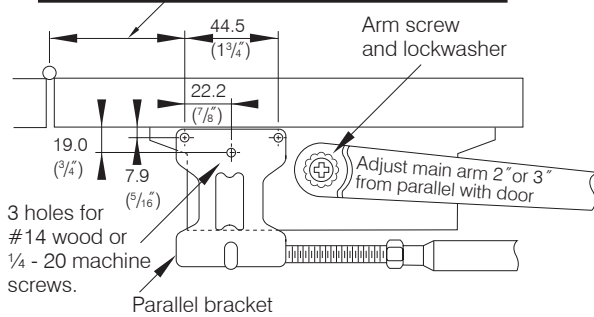

**Instructions**

- Step 1**  
A. Check hand of door.  
B. Select type of installation.
- Step 2**  
A. See instructions for installation you have selected.  
B. Follow instructions for correct application and adjustment.
- Step 3**  
A. Apply closer body and forearm (or parallel bracket and forearm) to door and frame as shown.  
B. Place main arm on shaft at proper index mark as shown and tighten arm screw with lockwasher securely.  
C. Adjust length of forearm as shown and attach to main arm at elbow and tighten locknut.
- Step 4**  
Snap cover cap over shaft at unused side.
- Step 5**  
Door closing and latching speeds are controlled by #1, #2 speed.  
Regulating screw separately.  
A. Clockwise turns slow the speed.  
B. Counterclockwise turns increase the speed.

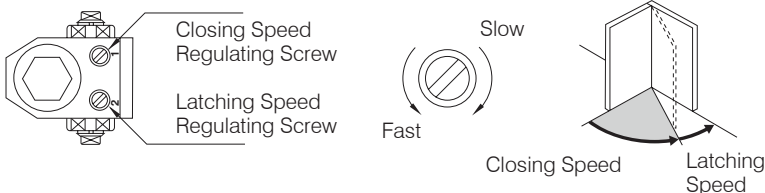



TITLE **BUDGET / CONTRACT CLOSER  
FC-3000 SERIES**

SHEET No.  
**3:21**

SUB TITLE **HOLD OPEN ARM (FRICTION TYPE) FC-422-AL**

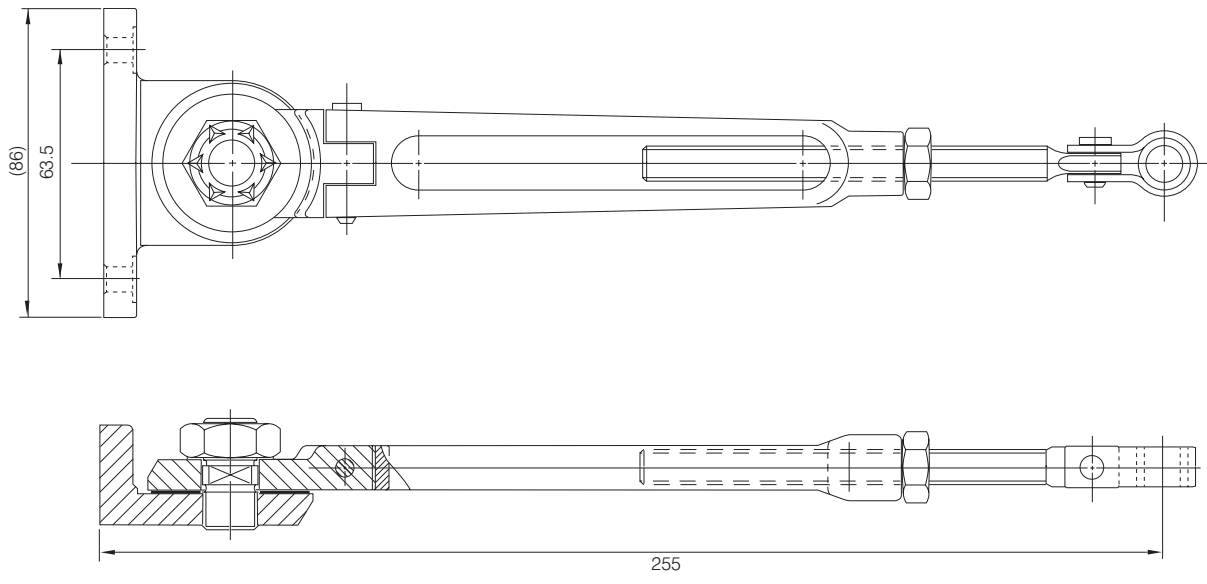

**The Parkside Group Ltd**

The Willow Centre  
17 Willow Lane, Mitcham, Surrey, CR4 4NX  
Tel: 020-8685 9685 Fax: 020-8646 5096  
Email: axim@parksidegroup.co.uk  
Web Site: www.axim.co.uk

SCALE	NTS @A4
DATE	MARCH 2014

For scaled technical or CAD drawings,  
please contact AXIM.

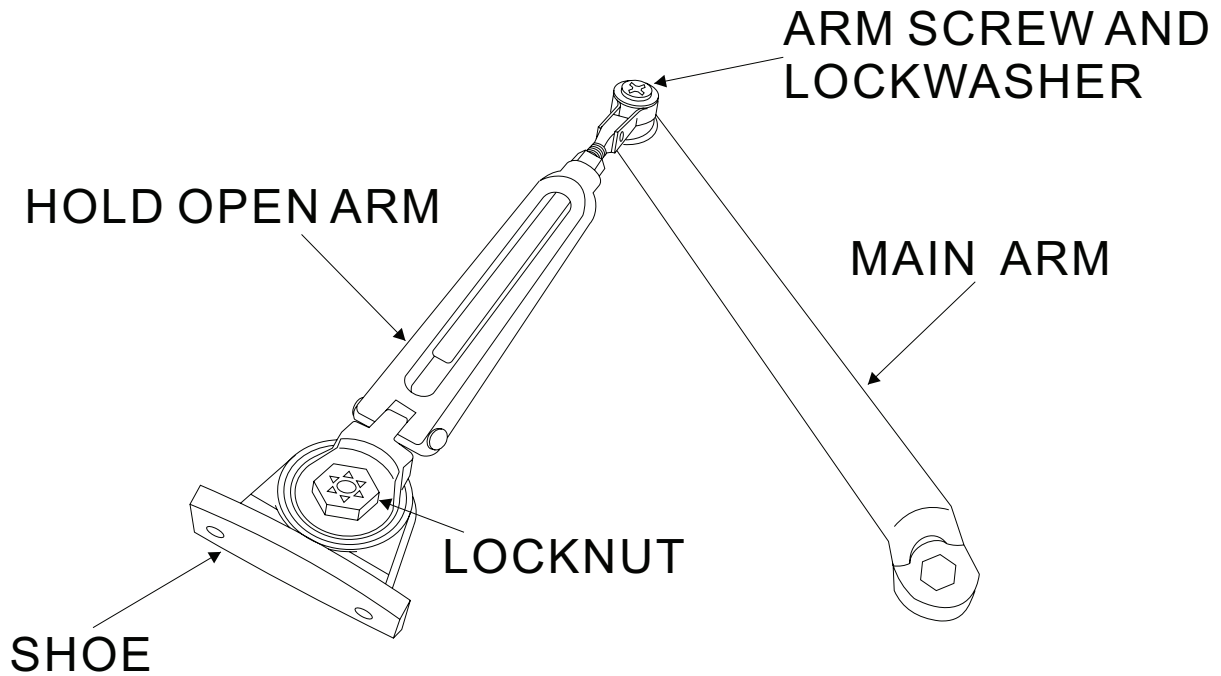

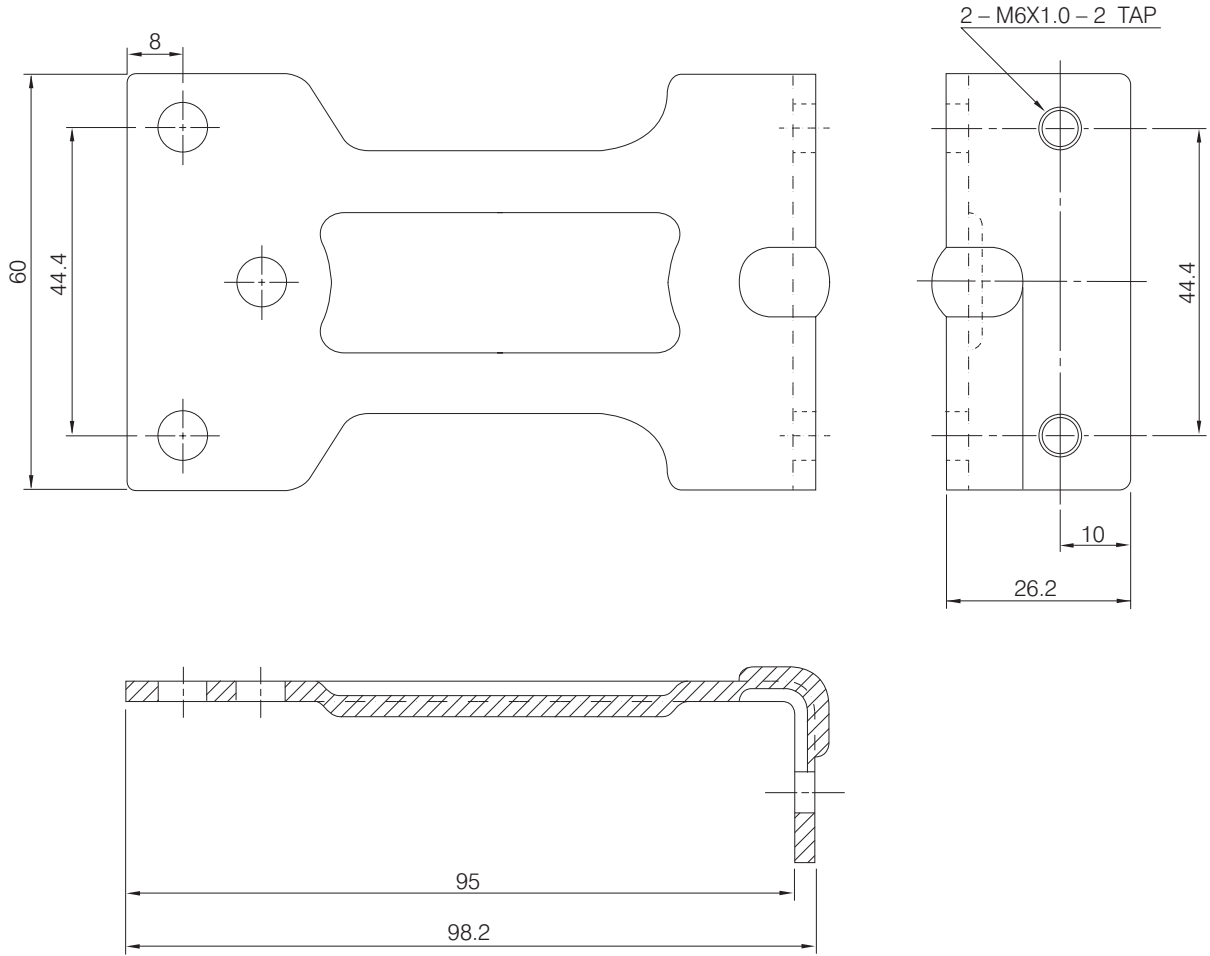



TITLE	<b>BUDGET / CONTRACT CLOSER FC-3000 SERIES</b>	SHEET No. <b>3:24</b>
SUB TITLE	<b>INTENTIONALLY BLANK</b>	

INTENTIONALLY  
BLANK



**The Parkside Group Ltd**

The Willow Centre  
17 Willow Lane, Mitcham, Surrey, CR4 4NX  
Tel: 020-8685 9685 Fax: 020-8646 5096  
Email: axim@parksidegroup.co.uk  
Web Site: www.axim.co.uk

SCALE	NTS @A4
DATE	NOVEMBER 2019
For scaled technical or CAD drawings, please contact AXIM.	



TITLE **BUDGET / CONTRACT CLOSER  
FC-3000 SERIES**

SHEET No.  
**3:25**

SUB TITLE **HOLD OPEN ARM (PLUNGER TYPE) FC3000-122-AL**

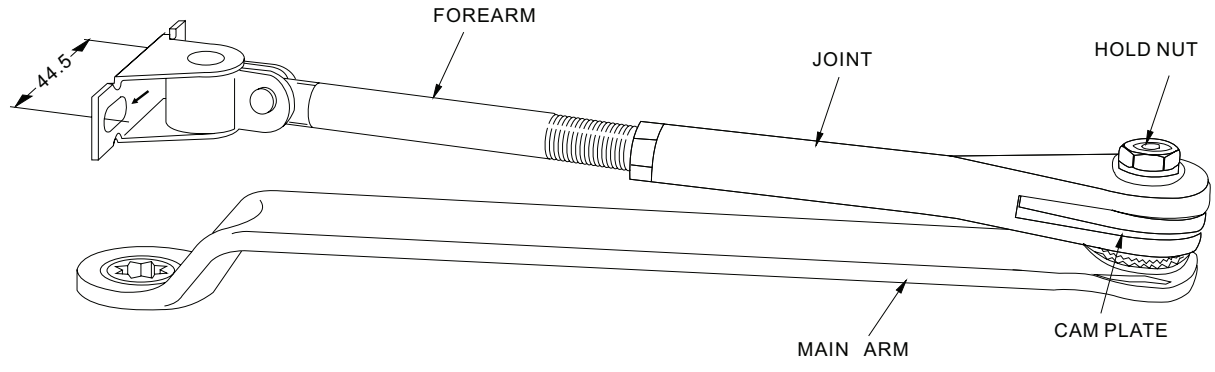

**The Parkside Group Ltd**

The Willow Centre  
17 Willow Lane, Mitcham, Surrey, CR4 4NX  
Tel: 020-8685 9685 Fax: 020-8646 5096  
Email: [axim@parksidegroup.co.uk](mailto:axim@parksidegroup.co.uk)  
Web Site: [www.axim.co.uk](http://www.axim.co.uk)

SCALE	NTS @A4
DATE	MARCH 2014

For scaled technical or CAD drawings,  
please contact AXIM.

