

6 x clearance holes to suit M6 screws. Typ.

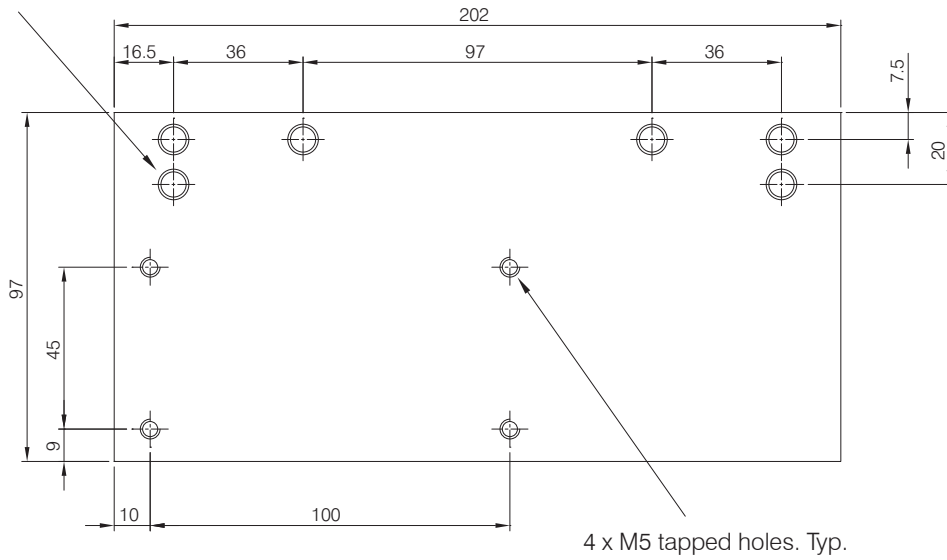

**FC-1000-12-AL**

Backplate for use with FC1000 series surface closers on parallel arm installation

4 x M5 tapped holes. Typ.

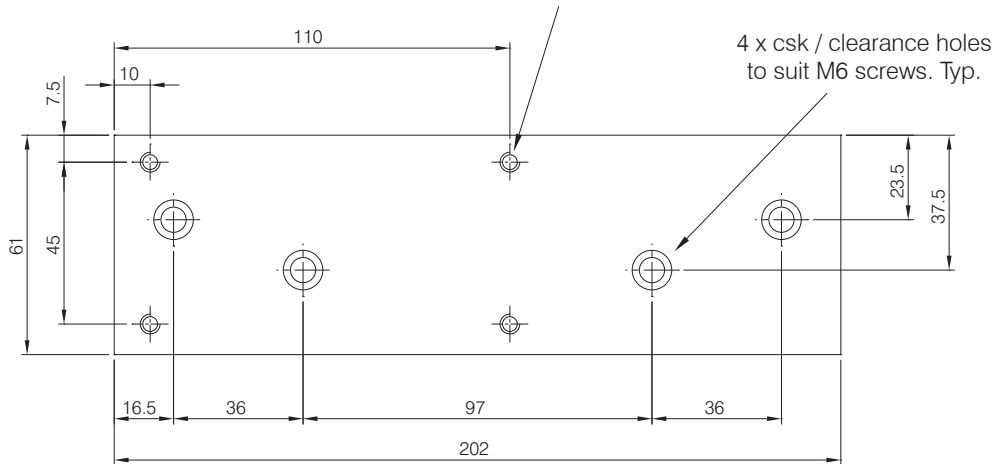

**FC-1000-14-AL**

Backplate for use with FC1000 series surface closers on standard and top jamb installation



**THE PARKSIDE GROUP LTD**

THE WILLOW CENTRE  
17 WILLOW LANE, MITCHAM, SURREY, CR4 4NX  
Tel: 020-8685 9685 Fax: 020-8646 5096  
Email: axim@parksidegroup.co.uk  
Web Site: <http://www.axim.co.uk>

SCALE	NTS @A4
DATE	MARCH 2014
For scaled technical or CAD drawings, please contact AXIM.	

ISO view not to scale

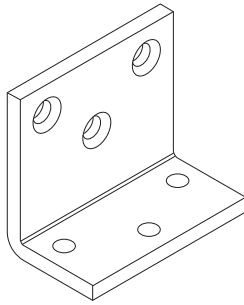

**Material:** Mild steel  
**Finish:** Zinc plating + silver,  
bronze or white PPC

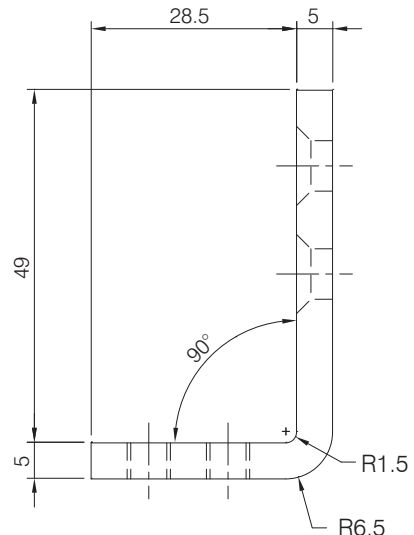
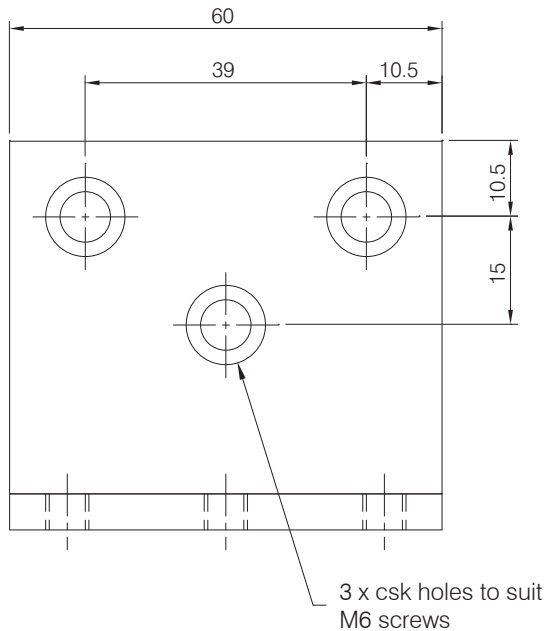
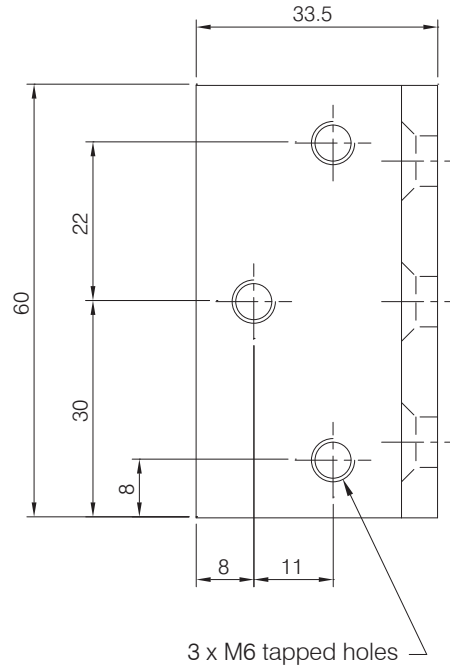

## THE PARKSIDE GROUP LTD

THE WILLOW CENTRE  
17 WILLOW LANE, MITCHAM, SURREY, CR4 4NX  
Tel: 020-8685 9685 Fax: 020-8646 5096  
Email: [axim@parksidegroup.co.uk](mailto:axim@parksidegroup.co.uk)  
Web Site: <http://www.axim.co.uk>

SCALE	NTS @A4
DATE	MARCH 2014
For scaled technical or CAD drawings, please contact AXIM.	

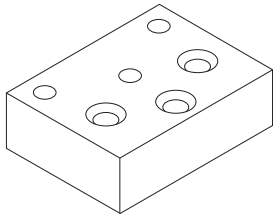

ISO view not to scale

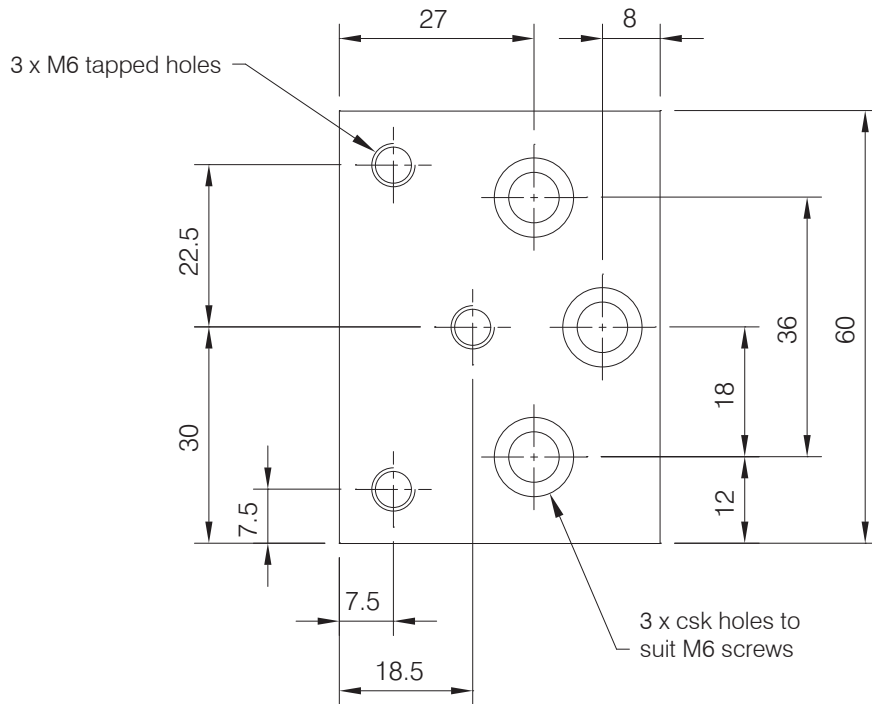
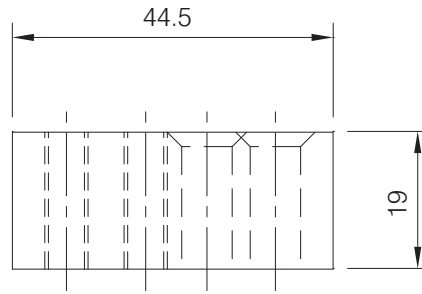

**Material:** Aluminium  
**Finish:** Mill finish



## THE PARKSIDE GROUP LTD

THE WILLOW CENTRE  
17 WILLOW LANE, MITCHAM, SURREY, CR4 4NX  
Tel: 020-8685 9685 Fax: 020-8646 5096  
Email: [axim@parksidegroup.co.uk](mailto:axim@parksidegroup.co.uk)  
Web Site: <http://www.axim.co.uk>

SCALE	NTS @A4
DATE	MARCH 2014
For scaled technical or CAD drawings, please contact AXIM.	

**Standard installation**

Closer mounted on door on pull side

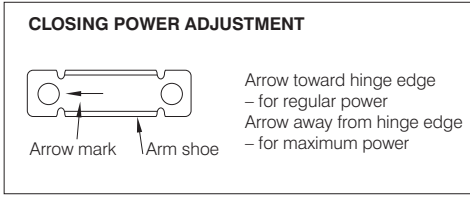
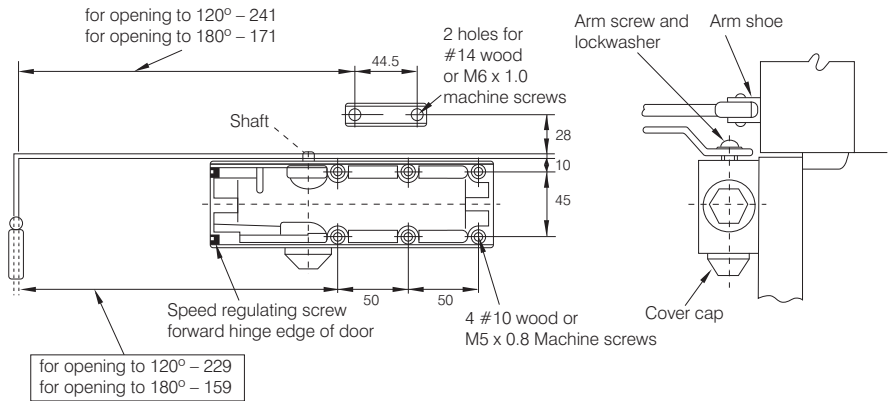
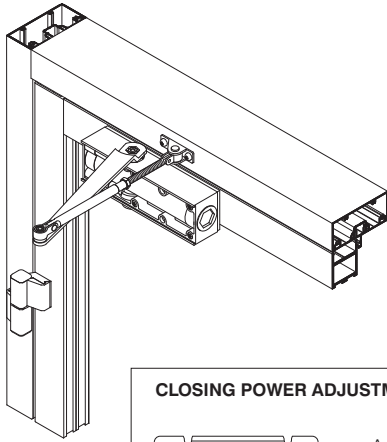

**Right hand door shown**  
Same dimensions apply for left hand door  
measured from hinge edge

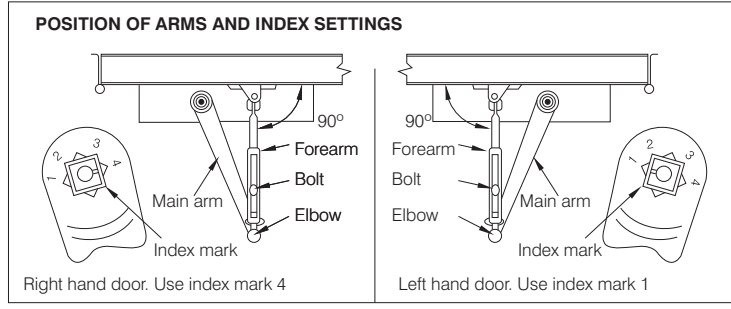

**Top jamb installation**

Closer mounted on top jamb on push side of door.  
Reveals of 70 to 127 requires long top jamb forearms

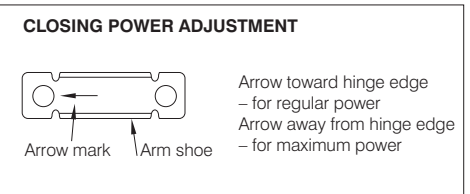
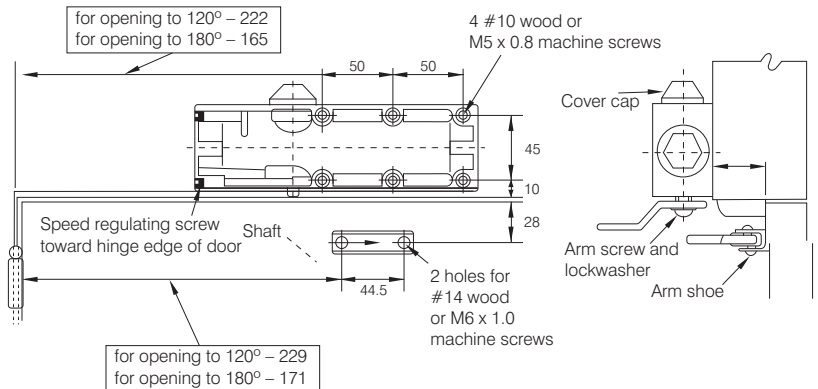
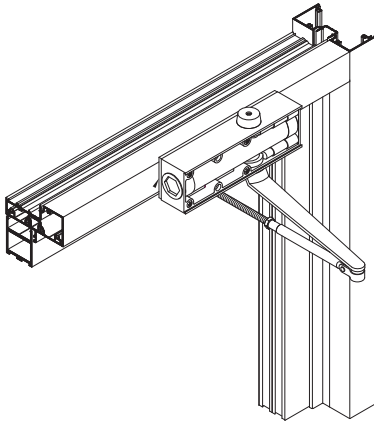

**Left hand door shown**  
Same dimensions apply for right hand door  
measured from hinge edge

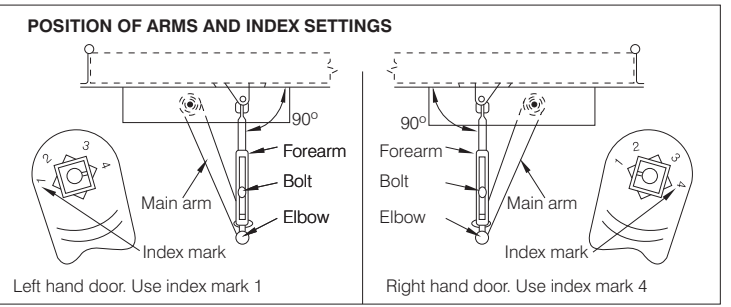

**THE PARKSIDE GROUP LTD**

THE WILLOW CENTRE  
17 WILLOW LANE, MITCHAM, SURREY, CR4 4NX  
Tel: 020-8685 9685 Fax: 020-8646 5096  
Email: axim@parksidegroup.co.uk  
Web Site: <http://www.axim.co.uk>

SCALE	NTS @A4
DATE	MARCH 2014
For scaled technical or CAD drawings, please contact AXIM.	

**Parallel arm installation**

Closer mounted on door on push side

**Left hand door shown**

Same dimensions apply for right hand door measured from hinge edge.

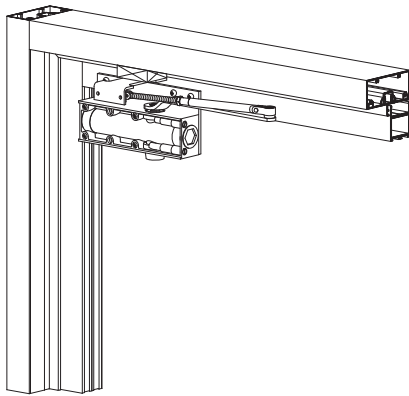
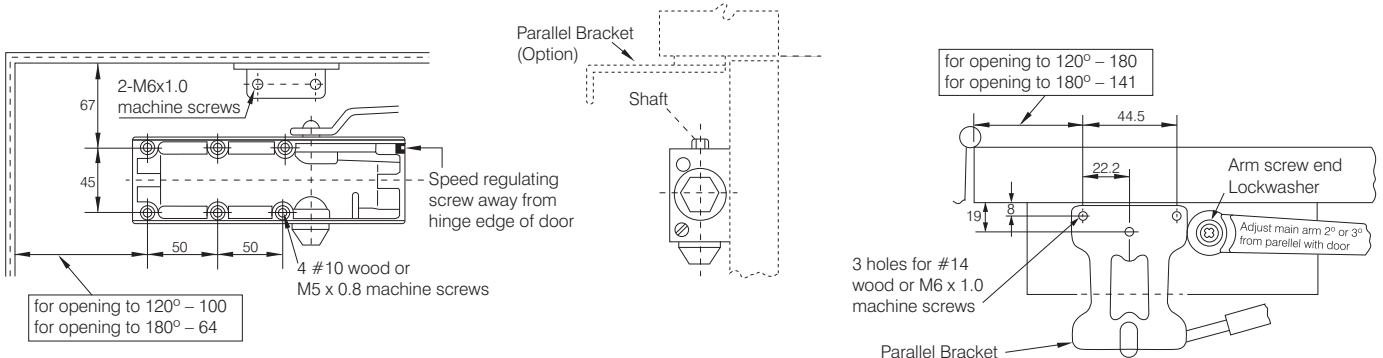

**POSITION OF ARMS AND INDEX SETTINGS**

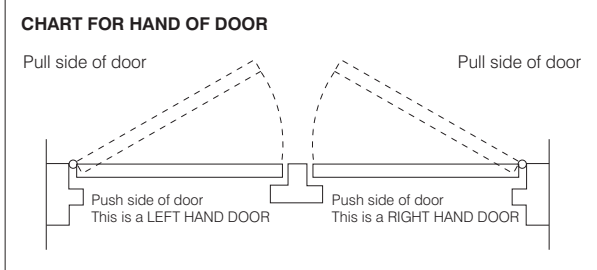
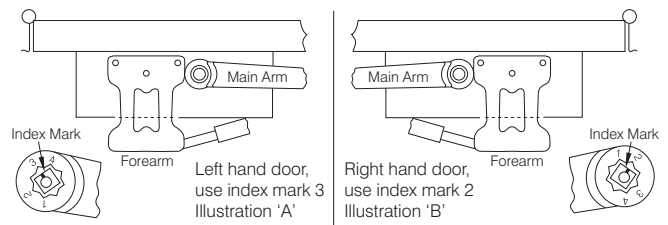

**Instructions**

- Step 1  
A. Check hand of door.  
B. Select type of installation.
- Step 2  
A. See instructions for installation you have selected.  
B. Follow instructions for correct application and adjustment.
- Step 3  
A. Apply closer body and forearm (or parallel bracket and forearm) to door and frame as shown.  
B. Place main arm on shaft at proper index mark as shown and tighten arm screw with lockwasher securely.  
C. Adjust length of forearm as shown and attach to main arm at elbow and tighten locknut bolt.
- Step 4  
Fixing cover cap on shaft at unused side and insert rubber plug into one of unused fixing hole on body then slide in the Faceplate.
- Step 5  
Door closing and latching speeds are controlled by #1, #2 speed regulating screw separately.  
A. Clockwise turns slow the Speed.  
B. Counterclockwise turns increase the speed.

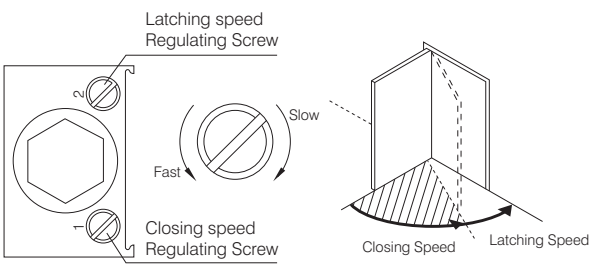

**THE PARKSIDE GROUP LTD**

THE WILLOW CENTRE  
17 WILLOW LANE, MITCHAM, SURREY, CR4 4NX  
Tel: 020-8685 9685 Fax: 020-8646 5096  
Email: axim@parksidegroup.co.uk  
Web Site: <http://www.axim.co.uk>

SCALE	NTS @A4
DATE	MARCH 2014
For scaled technical or CAD drawings, please contact AXIM.	